



HEALTH & HUMAN SERVICES AGENCY
San Benito County, CA

Housing Programs Overview

Community Services and Workforce Development (CSWD)

1111 San Felipe Road, Suite 107

Hollister, CA 95023

(831) 637-9293

Housing Options

There is no doubt that there is a housing shortage in San Benito County.

With the high cost of rents and cost of living, it's greatly impacting residents of SBC especially our low-income and homeless community members.

There is a need for different type of housing options ranging from:

- a. Emergency Shelter-including families
- b. Transitional Housing
- c. Low-Income Housing
- d. Permanent Supportive Housing
- e. Affordable Housing

Funding for Housing Options

Health & Human Services Agency has secured **\$9,025,000** for Capital Relating Housing Projects benefiting homeless individuals

- 2014 CDBG: \$1,500,000
- 2016 CDBG: \$1,500,000
- HEAP: \$1,875,000
- Transitional Housing Funding: \$1,450,000
- Whole Person Care Housing Funding: \$1,600,000
- HOME First Time Home Buyers Program: \$1.1 M

HOME Resource Center

Phase I – \$1.5 M

- Housing Opportunity Meals & Empowerment Service Center- 12/17
- Year-Round Shelter
- Provides shelter, 3 meals a day, transportation, showers, security, supportive services...
- 50 bed capacity: 28 males & 22 females
- **Annual Operating Budget: \$615,000**

Phase II- \$1.5 M-Whole Person Care- 5/19

Phase III- \$1.45 M-Transitional
Housing- 12/20



HOME Resource Center

Phase 1, II, & III



SAN BENITO COUNTY HOME RESOURCE CENTER, EMERGENCY
SHELTER, SERVICE CENTER & TRANSITIONAL HOUSING

Phase III- Transitional Housing, 8 units

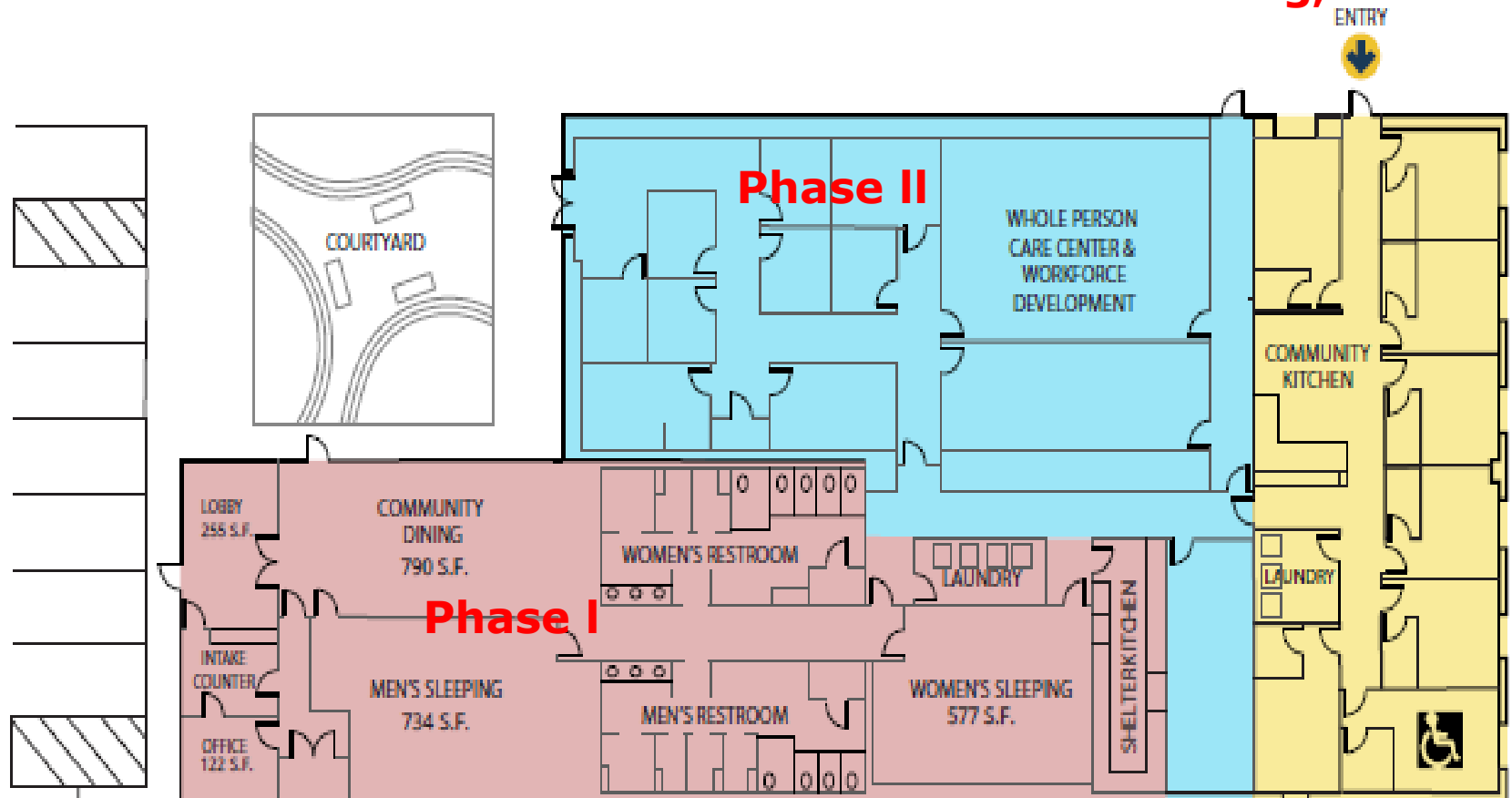

HEAP

Homeless Emergency Aid Program

Provides services to homeless adults and transition age youth in SBC



- ❑ Youth Services-Youth Alliance
- ❑ Rental Assistance- HHSA/CSWD
- ❑ Outreach Team- HHSA/CSWD, Sheriff's Dept.
- ❑ Transitional Housing Units-Migrant Center

Annual Budget: \$1,875,000

(\$1.1 M Capital)



HEAP

Transitional Housing



WPC Housing Grant

AWARD: \$1.6 Million

Purchase of a Home or Tri-Plex for WPC clients

Partner with a non-profit developer to invest funding for a low-income apartment complex and dedicate 6-8 units for eligible clients

HOME First Time Home Buyers (FTHB) Program

AWARD: \$1.1 Million

- ❑ Low-Income housing for first time home buyers.
- ❑ Community Services Development Corporation (CSDC) is the partner organization as the project sponsor for their Southside low-income housing project

Other Housing Related Supportive Services

- ❑ Tenant Based Rental Assistance: \$500,000
- ❑ Low-Income Heating Energy Assistance: \$350,000
- ❑ HH Permanent Supportive Housing: \$243,000
- ❑ CalWORKs Housing Supportive Program: \$430,000
- ❑ ESG Rapid Rehousing Program: \$116,000
- ❑ BH Housing Assistance: \$200,000

Other Housing Options

- ❑ San Benito County Migrant Center: \$390,000
- ❑ SBC Labor Camp- Farm Labor Association
- ❑ Mobile Park Transitional Housing- CSDC

SBC Migrant Center



Questions?



HEALTH & HUMAN SERVICES AGENCY
San Benito County, CA