

**INDEX TO PLANS**

SHEET NO.	DESCRIPTION
1	TITLE SHEET
2	IMPROVEMENT PLAN - SHORE ROAD
3	IMPROVEMENT PLAN - SAN FELIPE ROAD
4	CONSTRUCTION STAGING PLANS SHORE ROAD
5	CONSTRUCTION STAGING PLANS SAN FELIPE ROAD
6	GENERAL PLAN - SHORE ROAD
7	BARRIER RAIL DETAILS - SHORE ROAD
8	GENERAL PLAN - SAN FELIPE ROAD
9	BARRIER RAIL DETAILS - SAN FELIPE ROAD

**STATE OF CALIFORNIA**  
**COUNTY OF SAN BENITO**  
**PROJECT PLANS FOR CONSTRUCTION OF**  
**SAN FELIPE RD BRIDGE & SHORE RD BRIDGE**  
**BARRIER RAIL REPLACEMENT**  
**BRIDGE NUMBER - 43C0012**  
**BRIDGE NUMBER - 43C0051**  
**FEDERAL PROJECT NO. STPLX - 5943(057)**  
**COUNTY PROJECT NO. PWB-1908**  
 To be supplemented by Standard Plans and Standard  
 Specifications of the State of California Department of  
 Transportation dated 2015

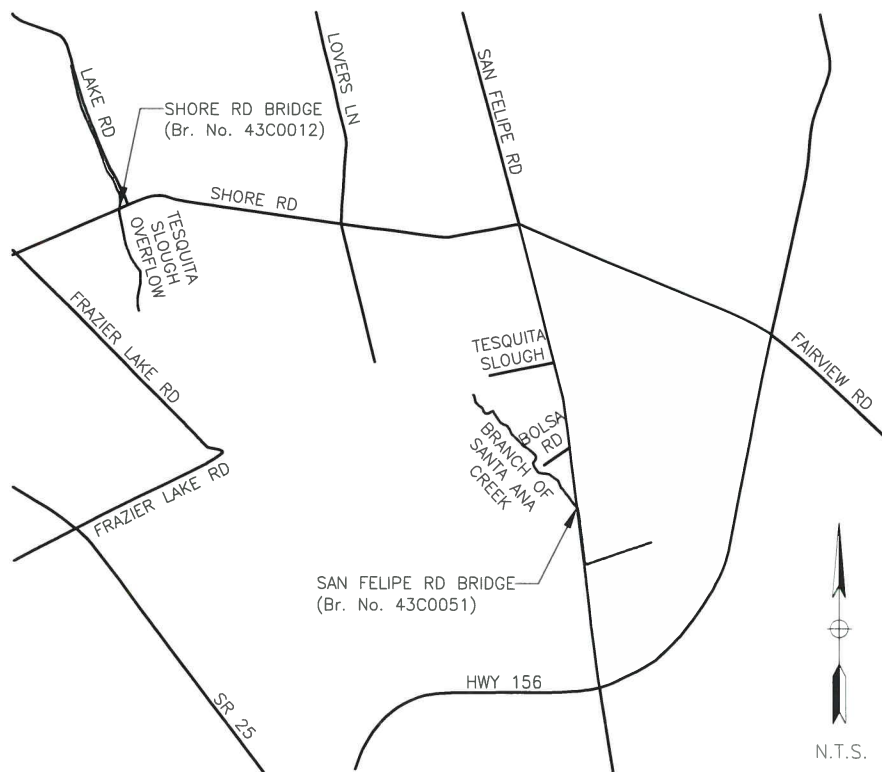

**PG&E Contact Information:**  
 Mario Marini  
 Gas Construction Supervisor  
 Pacific Gas and Electric Company  
 401 Work Street  
 Salinas, CA 93901  
 Tel. No. (831) 784-3579



Contractor shall call  
 Underground Service Alert at  
 811 two working days prior  
 to excavation

UNDERGROUND FACILITIES SHOWN WERE LOCATED BASED ON  
 INFORMATION PROVIDED BY UTILITY COMPANIES AND BY  
 MEASURING SURFACE FEATURES. NO ATTEMPT WAS MADE TO  
 LOCATE OTHER UNDERGROUND FACILITIES THAT WERE NOT  
 READILY APPARENT FROM A VISUAL INSPECTION OF SUR-  
 FACE FEATURES.

CONTRACTOR SHALL VERIFY ACTUAL DEPTH AND LOCATION OF  
 ALL EXISTING UTILITIES PRIOR TO CONSTRUCTION...CALL  
 "UNDERGROUND SERVICE ALERT" (U.S.A.) PRIOR TO TRENCHING,  
 GRADING, EXCAVATION, DRILLING, PIPE PUSHING, PLANTING  
 TREES, DIGGING POST HOLES FOR FENCES, ETC. U.S.A. WILL  
 SUPPLY INFORMATION OR LOCATE AND MARK ANY  
 UNDERGROUND FACILITIES.

ALL DIMENSIONS ARE IN  
 FEET UNLESS OTHERWISE SHOWN

The Contractor shall possess the Class (or Classes) of license as specified  
 in the "Notice to Bidders" contained in the Special Provisions

DIST	COUNTY	ROUTE	KILOMETER TOTAL PROJECT	POST TOTAL PROJECT	SHEET No	TOTAL SHEETS
5	SBT				1	9

*Shawn M. Cullers* 4/22/19  
 REGISTERED STRUCTURAL ENGINEER



PLANS APPROVAL DATE  
 The State of California or its officers or agents  
 shall not be responsible for the accuracy or  
 completeness of scanned copies of this plan sheet.

CORNERSTONE STRUCTURAL  
 ENGINEERING GROUP  
 986 W. Alluvial Ave, Suite 201  
 Fresno, California 93711  
 (559)320-3200

SAN BENITO COUNTY  
 PUBLIC WORKS DEPARTMENT  
 2301 Technology Parkway  
 Hollister, CA 95023



Approved by:  
*Edgar Nolasco*  
 Edgar Nolasco, Deputy CAO  
 San Benito County

4/23/19  
 Date

Signed by:  
*Shawn M. Cullers* 4/22/19  
 Shawn M. Cullers, SE Project Manager  
 Cornerstone Structural Engineering Group

DESIGN	BY	CHECKED	LRFD	LIVE LOADING: "LOAD & RESISTANCE FACTOR DESIGN" & "HSB W/ 'LOW BOY' & PERMIT DESIGN VEHICLE"	PREPARED FOR THE	BRIDGE NO.	SAN FELIPE RD & SHORE RD BARRIER RAIL REPLACEMENT
DESIGN OVERSIGHT	Narciso Zermeno	Mark Weaver			Shawn Cullers		
DETAILS	Narciso Zermeno	Mark Weaver	LAYOUT	BY Shawn Cullers	PROJECT ENGINEER	POST MILE	
QUANTITIES	Narciso Zermeno	Mark Weaver	SPECIFICATIONS	BY Shawn Cullers			
PLANS AND SPECS COMPARED				Shawn Cullers			

Rev. Date 11-13-07

ORIGINAL SCALE IN INCHES  
 FOR REDUCED PLANS

0 1 2 3

CU  
 EA

PROJECT ID

DISREGARD PRINTS BEARING  
 EARLIER REVISION DATES

REVISION DATES SHEET OF  
 1 1

DIST	COUNTY	ROUTE	KILOMETER TOTAL	POST PROJECT	SHEET No	TOTAL SHEETS
5	SBT				2	9

March 13, 2019  
 REGISTERED CIVIL ENGINEER  
 No. C-45003  
 Exp. 3/31/22  
 CIVIL ENGINEER  
 STATE OF CALIFORNIA

The State of California or its officers or agents shall not be responsible for the accuracy or completeness of scanned copies of this plan sheet.

NVS, Inc. 2325 Gateway Place, Suite 238 San Jose, California 95110 (408) 392-7200	SAN BENITO COUNTY PUBLIC WORKS DIVISION 2301 Technology Parkway Hollister, CA 95023
--	--

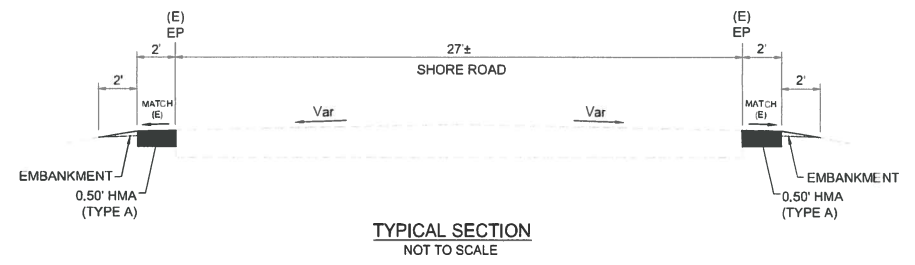

- LEGEND**
- (No) PAVEMENT DELINEATION DETAIL NUMBER PER CALTRANS STANDARD PLANS A20A TO A20D
  - +—+— LIMITS OF DESIGNATED TRAFFIC STRIPE
- ABBREVIATIONS**
- AC ASPHALT CONCRETE
  - AFTS ALTERNATIVE FLARED TERMINAL SYSTEM
  - AITS ALTERNATIVE IN-LINE TERMINAL SYSTEM
  - (E) EXISTING
  - EP EDGE OF PAVEMENT
  - HP HIGH PRESSURE
  - Min MINIMUM
  - MGS MIDWEST GUARDRAIL SYSTEM
  - PP POWER POLE
  - R/W RIGHT OF WAY
  - Trans TRANSITION
  - Typ TYPICAL
  - Var VARIES
  - W/ WITH
  - & AND

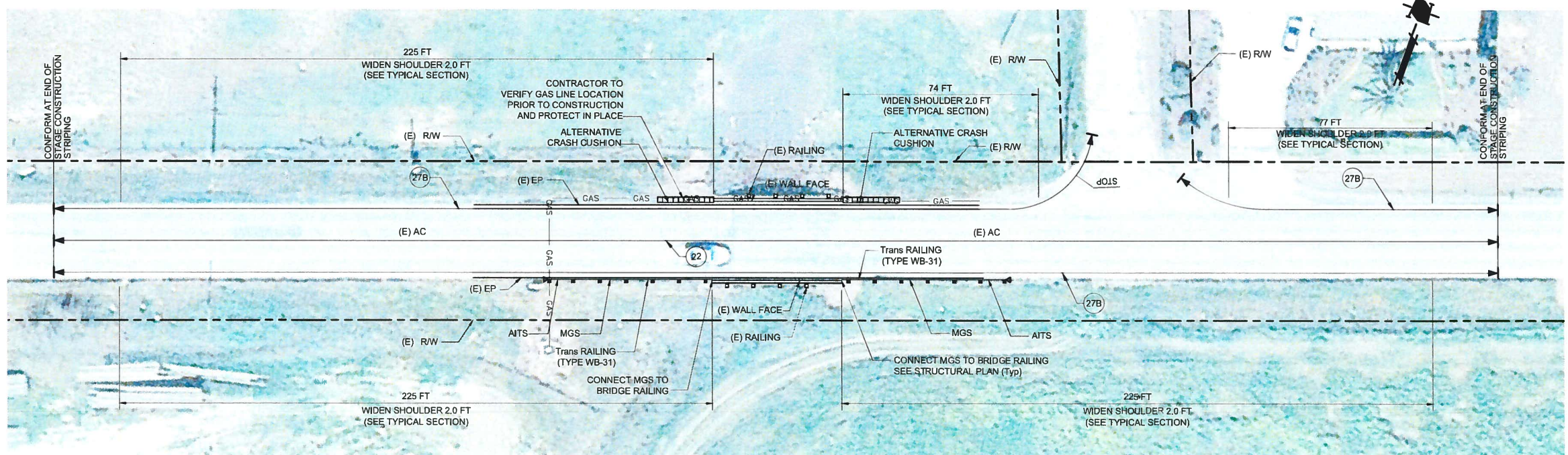

ALL DIMENSIONS ARE IN FEET UNLESS OTHERWISE SHOWN

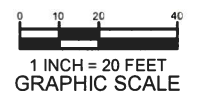

DESIGN OVERSIGHT	DESIGN BY	CHECKED	LAYOUT BY	CHECKED	PREPARED FOR THE COUNTY OF SAN BENITO PUBLIC WORKS DIVISION	BRIDGE NO.	SAN FELIPE RD & SHORE RD BARRIER RAIL REPLACEMENT
SIGN OFF DATE	DETAILS BY	CHECKED	SPECIFICATIONS BY	PLANS AND SPECS COMPARED	PROJECT ENGINEER Jack Walker	POST MILE	
Rev Date: March 13, 2019	QUANTITIES BY	CHECKED				PROJECT ID	IMPROVEMENT PLAN - SHORE ROAD
				ORIGINAL SCALE IN INCHES FOR REDUCED PLANS	CU EA	DISREGARD PRINTS BEARING EARLIER REVISION DATES	REVISION DATES SHEET OF
						4/6/13/19	1 4

DATE PLOTTED => 3/13/2019 TIME PLOTTED => 4:28:37 PM



DIST	COUNTY	ROUTE	KILOMETER POST TOTAL PROJECT	SHEET No	TOTAL SHEETS
5	SBT			3	9

*Linda M Grevera* 05-29-18  
REGISTERED CIVIL ENGINEER

PLANS APPROVAL DATE \_\_\_\_\_

The State of California or its officers or agents shall not be responsible for the accuracy or completeness of scanned copies of this plan sheet.

HMH ENGINEERS  
1570 Oakland Road  
San Jose, California 95131  
(408) 487-2200

SAN BENITO COUNTY  
PUBLIC WORKS DIVISION  
2301 Technology Parkway  
Hollister, CA 95023

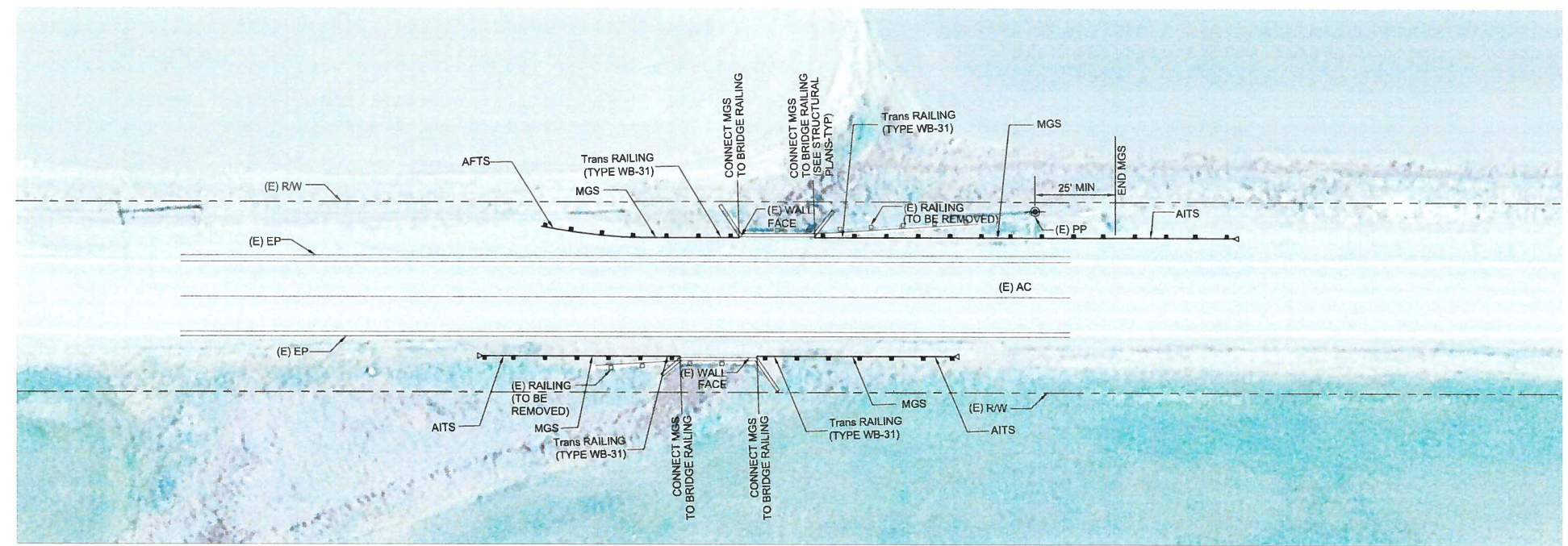
## SAN FELIPE ROAD

**ABBREVIATIONS**

AC	ASPHALT CONCRETE
AFTS	ALTERNATIVE FLARED TERMINAL SYSTEM
AITS	ALTERNATIVE IN-LINE TERMINAL SYSTEM
(E)	EXISTING
EP	EDGE OF PAVEMENT
HP	HIGH PRESSURE
MIN	MINIMUM
MGS	MIDWEST GUARDRAIL SYSTEM
PP	POWER POLE
R/W	RIGHT OF WAY
Trans	TRANSITION
TYP	TYPICAL
VAR	VARIABLE
W/	WITH
&	AND

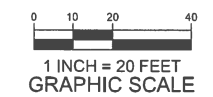

ALL DIMENSIONS ARE IN FEET UNLESS OTHERWISE SHOWN











DESIGN OVERSIGHT	DESIGN BY	CHECKED	LAYOUT BY	Linda M. Grevera	CHECKED	PREPARED FOR THE <b>COUNTY OF SAN BENITO</b> PUBLIC WORKS DIVISION	BRIDGE NO.	<b>SAN FELIPE RD &amp; SHORE RD BARRIER RAIL REPLACEMENT</b>
SIGN OFF DATE	DETAILS BY	CHECKED	SPECIFICATIONS BY	Linda M. Grevera	PLANS AND SPECS COMPARED	PROJECT ENGINEER	POST MILE	IMPROVEMENT PLAN - SAN FELIPE ROAD
Rev. Date: 11-13-07	ORIGINAL SCALE IN INCHES FOR REDUCED PLANS					CU EA	PROJECT ID	DISREGARD PRINTS BEARING EARLIER REVISION DATES
						0	1	2
						3	4/6/11	2 OF 4

FILE => S:\Projects\458800\PW\IMPROVEMENT PLANS\458800IP01.dwg

DATE PLOTTED => 5/29/2018 TIME PLOTTED => 6:33:12 AM USERNAME => lgrevera



**LEGEND**

-  CONSTRUCTION THIS PHASE
-  TEMPORARY RAILING (TYPE K)
-  TEMPORARY CRASH CUSHION
-  CHANNELIZERS (SURFACE MOUNTED)
-  TYPE "P" MARKER
-  CONSTRUCTION AREA SIGN
-  DIRECTION OF VEHICLE TRAFFIC
-  LIMIT OF DESIGNATED TRAFFIC STRIPE
-  PAVEMENT DELINEATION DETAIL PER CALTRANS STANDARD PLANS A20A TO A20d
-  TEMPORARY ALTERNATIVE CRASH CUSHION

**ABBREVIATIONS**

- AC ASPHALT CONCRETE
- (E) EXISTING
- EP EDGE OF PAVEMENT
- HP HIGH PRESSURE
- Min MINIMUM
- PP POWER POLE
- R/W RIGHT OF WAY
- Typ TYPICAL
- Var VARIES
- W/ WITH
- & AND

**SIGN LEGEND**

- W20-1 ROAD WORK AHEAD
- W13-1P SPEED LIMIT
- G20-2 END ROAD WORK
- W5-1 ROAD NARROWS
- W13-1P ADVISORY SPEED
- W1-4 HORIZONTAL ALIGNMENT SIGN
- CMS CHANGEABLE MESSAGE SIGN

**NOTES**

1. PROVIDE ALL ADDITIONAL SIGNS NOT SHOWN TO MEET MUTCD REQUIREMENTS.
2. STAGE CONSTRUCTION PLANS DO NOT SHOW ALL WORK REQUIRED TO BE COMPLETED.
3. ALL STATIONING AND OFFSETS OF TEMPORARY RAILING (TYPE K) ARE TO THE CENTERLINE OF THE TEMPORARY RAILING.
4. CHANNELIZERS (SURFACE MOUNTED) SHOWN ARE SPACED 20 FEET APART UNLESS OTHERWISE NOTED.
5. LOCATION OF CONSTRUCTION AREA SIGNS ARE APPROXIMATE, EXACT LOCATIONS ARE TO BE DETERMINED BY THE ENGINEER.
6. CONTRACTOR SHALL MAINTAIN DRIVEWAY ACCESS TO PROPERTY OWNERS UNLESS APPROVED OTHERWISE BY SAID PROPERTY OWNER.
7. PULL BOXES EXPOSED TO ANY VEHICULAR TRAFFIC TO BE TRAFFIC RATED.
8. CONTRACTOR MUST LOCATE GAS LINE PRIOR TO BEGINNING ANY CONSTRUCTION IN THAT AREA.

DIST	COUNTY	ROUTE	KILOMETER POST TOTAL PROJECT	SHEET No	TOTAL SHEETS
5	SBT			4	9

March 13, 2019  
REGISTERED CIVIL ENGINEER



PLANS APPROVAL DATE

The State of California or its officers or agents shall not be responsible for the accuracy or completeness of scanned copies of this plan sheet.

NVS, Inc.  
2325 Gateway Place, Suite 238  
San Jose, California 95110  
(408) 392-7200

SAN BENITO COUNTY  
PUBLIC WORKS DIVISION  
2301 Technology Parkway  
Hollister, CA 95023

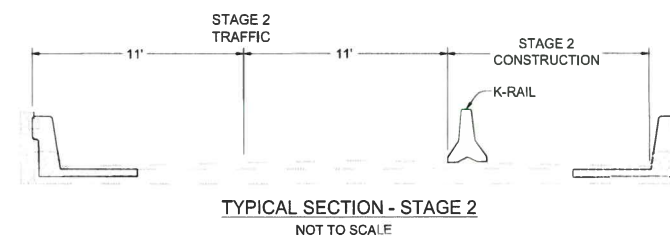
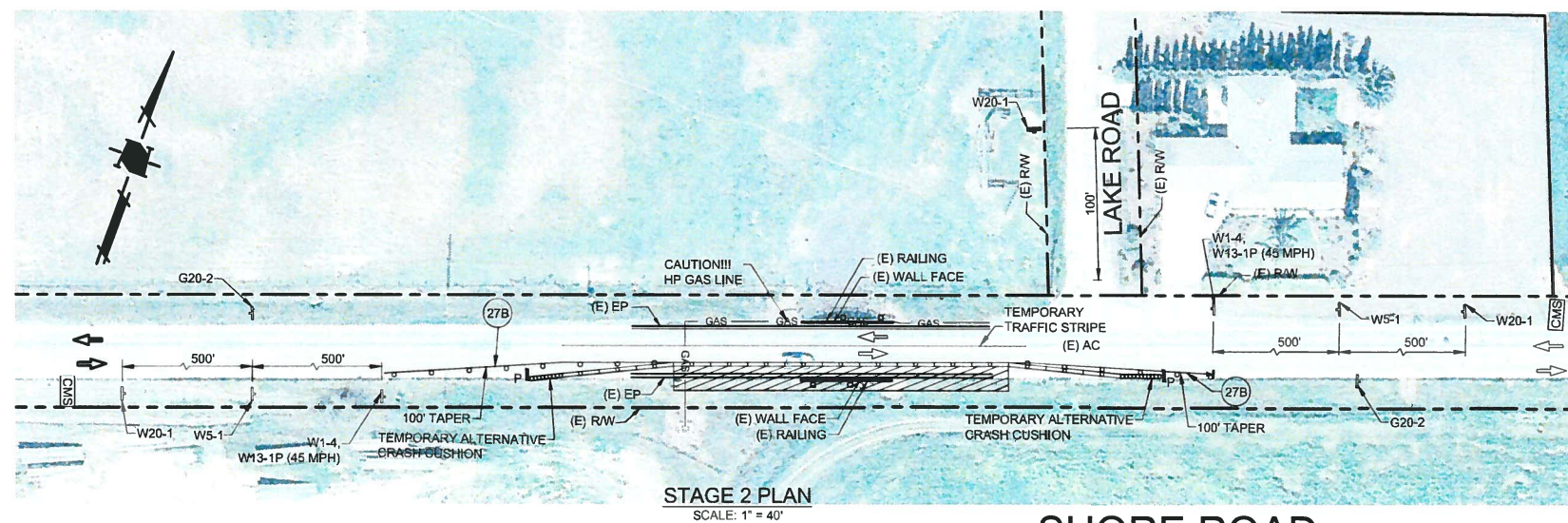
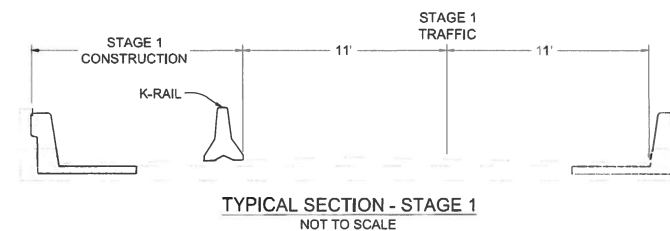
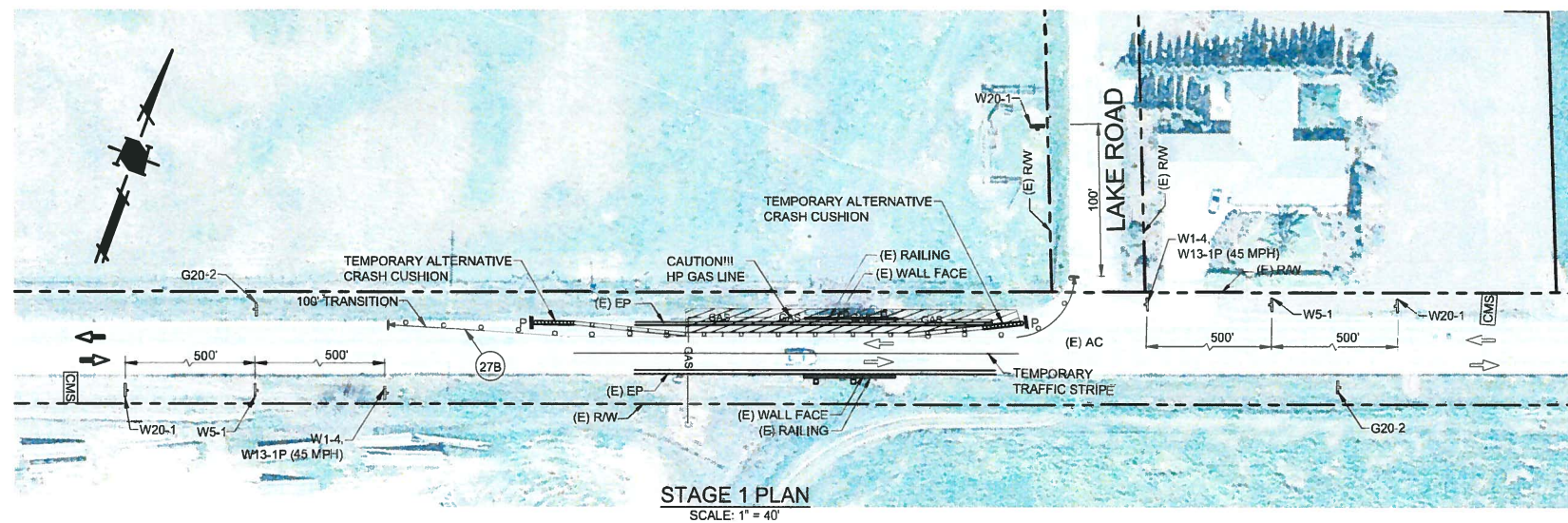

ALL DIMENSIONS ARE IN FEET UNLESS OTHERWISE SHOWN

**SHORE ROAD**

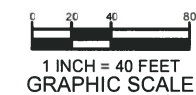

DESIGN OVERSIGHT	DESIGN BY	CHECKED	LAYOUT BY	CHECKED	PREPARED FOR THE COUNTY OF SAN BENITO PUBLIC WORKS DIVISION	PROJECT ENGINEER Jack Walker	BRIDGE NO.	<b>SAN FELIPE RD &amp; SHORE RD BARRIER RAIL REPLACEMENT</b>		
DETAILS	BY	CHECKED	BY	CHECKED			POST MILE	CONSTRUCTION STAGING PLANS SHORE ROAD		
QUANTITIES	BY	CHECKED	BY	CHECKED						
Rev Date: March 13, 2019	ORIGINAL SCALE IN INCHES FOR REDUCED PLANS				CJ EA	PROJECT ID	DISREGARD PRINTS BEARING EARLIER REVISION DATES	REVISION DATES	SHEET	OF
								4/6/5/13/19	3	4

DATE PLOTTED => 3/13/2019 TIME PLOTTED => 4:30:30 PM



DIST	COUNTY	ROUTE	KILOMETER POST TOTAL PROJECT	SHEET No	TOTAL SHEETS
5	SBT			5	9

Linda M Grevera 05-29-18  
REGISTERED CIVIL ENGINEER



PLANS APPROVAL DATE

The State of California or its officers or agents shall not be responsible for the accuracy or completeness of scanned copies of this plan sheet.

HMH ENGINEERS  
1570 Oakland Road  
San Jose, California 95131  
(408) 487-2200

SAN BENITO COUNTY  
PUBLIC WORKS DIVISION  
2301 Technology Parkway  
Hollister, CA 95023

**LEGEND**

- CONSTRUCTION THIS PHASE
- TEMPORARY RAILING (TYPE K)
- TEMPORARY CRASH CUSHION
- CHANNELIZERS
- TYPE "P" OR "R" MARKER
- CONSTRUCTION AREA SIGN
- DIRECTION OF VEHICLE TRAFFIC
- LIMIT OF DESIGNATED TRAFFIC STRIPE
- PAVEMENT DELINEATION DETAIL

**ABBREVIATIONS**

- AC ASPHALT CONCRETE
- (E) EXISTING
- EP EDGE OF PAVEMENT
- HP HIGH PRESSURE
- MIN MINIMUM
- PP POWER POLE
- R/W RIGHT OF WAY
- TYP TYPICAL
- VAR VARIES
- W/ WITH
- & AND

**NOTES**

- PROVIDE ALL ADDITIONAL SIGNS NOT SHOWN TO MEET MUTCD REQUIREMENTS.
- STAGE CONSTRUCTION PLANS DO NOT SHOW ALL WORK REQUIRED TO BE COMPLETED.
- ALL STATIONING AND OFFSETS OF TEMPORARY RAILING (TYPE K) ARE TO THE CENTERLINE OF THE TEMPORARY RAILING.
- ALL LIMIT LINES SHALL BE 8 INCH SOLID WHITE STRIPE.
- CHANNELIZERS (SURFACE MOUNTED) SHOWN ARE SPACED 20 FEET APART UNLESS OTHERWISE NOTED.
- LOCATION OF CONSTRUCTION AREA SIGNS ARE APPROXIMATE, EXACT LOCATIONS ARE TO BE DETERMINED BY THE ENGINEER.
- CONTRACTOR SHALL MAINTAIN DRIVEWAY ACCESS TO PROPERTY OWNERS UNLESS APPROVED OTHERWISE BY SAID PROPERTY OWNER.
- PULL BOXES EXPOSED TO ANY VEHICULAR TRAFFIC TO BE TRAFFIC RATED.
- STAGE CONSTRUCTION SPEED LIMIT ON SAN FELIPE ROAD IS 45 MPH.

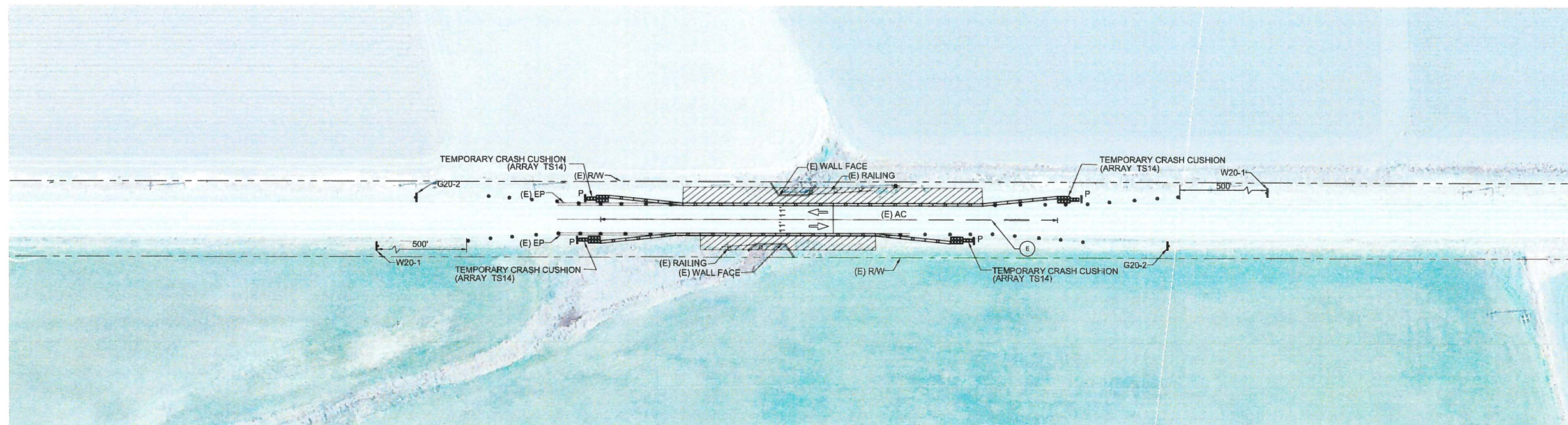

**SAN FELIPE ROAD**

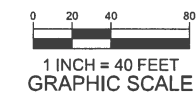

ALL DIMENSIONS ARE IN FEET UNLESS OTHERWISE SHOWN

DESIGN OVERSIGHT	DESIGN	BY	CHECKED	LAYOUT	BY	CHECKED	PLANS AND SPECS COMPAIRED	PREPARED FOR THE <b>COUNTY OF SAN BENITO</b> PUBLIC WORKS DIVISION	Linda M. Grevera PROJECT ENGINEER	BRIDGE NO.	<b>SAN FELIPE RD &amp; SHORE RD BARRIER RAIL REPLACEMENT</b>			
SIGN OFF DATE	DETAILS	BY	CHECKED	SPECIFICATIONS	BY	CHECKED				POST MILE	CONSTRUCTION STAGING PLANS SAN FELIPE ROAD			
Rev. Date: 11-13-07	QUANTITIES	BY	CHECKED		BY	CHECKED		ORIGINAL SCALE IN INCHES FOR REDUCED PLANS	CU EA	PROJECT ID	DISREGARD PRINTS BEARING EARLIER REVISION DATES	REVISION DATES	SHEET	OF
					Linda M. Grevera			0 1 2 3			4/6/11	4	4	

FILE => S:\Projects\458800\PW\IMPROVEMENT PLANS\458800SC02.dwg

DATE PLOTTED => 5/29/2018 TIME PLOTTED => 6:43:51 AM USERNAME => lgrevera

**Legend:**

- ① MWS, see Road Plans
- ② Alternative Crash Cushion, see Road Plans
- ③ Temporary K-Rail, see Road Plans Attach to deck slab per T3A
- ④ Existing gas line to remain (protect in place)
- Indicates appropriate limits of bridge removal
- Indicates existing structure
- B0-3 Indicates Caltrans standard plan sheet no.
- 3-1 Indicates detail no.

**General Notes:**

Design: AASHTO LRFD Bridge Design Specifications, 6th Edition and the Caltrans Amendments Preface dated January 2014.

TL-4 Traffic Railing ( $F_T = 54.0$  Kips)

Reinforced Concrete:  $f'_c = 3.6$  ksi  
 $f_y = 60$  ksi  
 $n = 8.0$

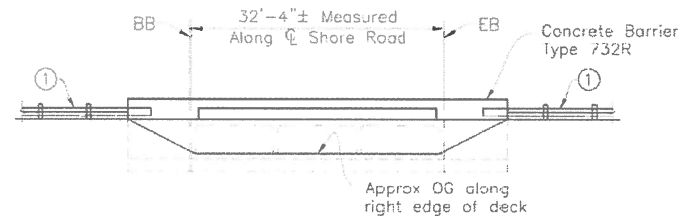

**ELEVATION**  
1"=10'-0"

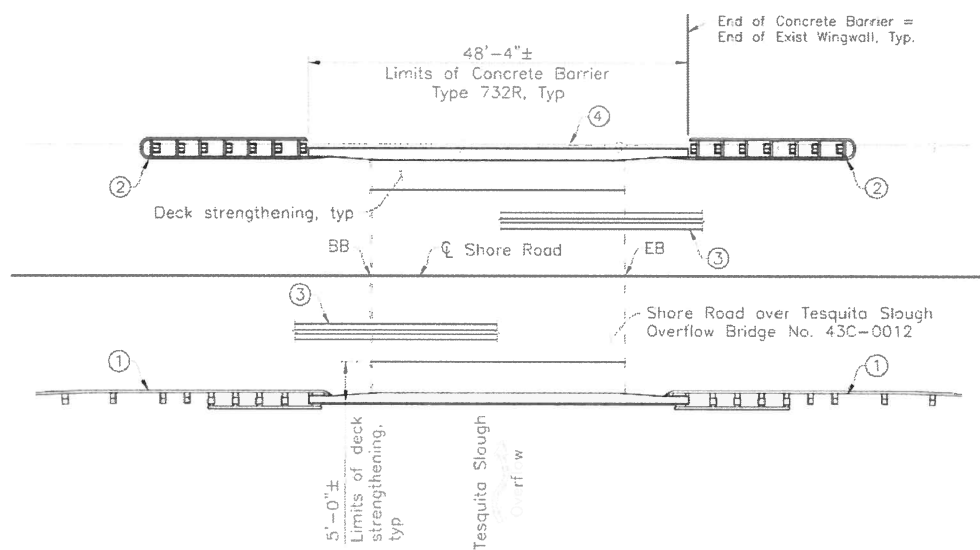

**PLAN**  
1"=10'-0"

ALL DIMENSIONS ARE IN FEET UNLESS OTHERWISE SHOWN

DIST	COUNTY	ROUTE	KILOMETER POST TOTAL PROJECT	SHEET No.	TOTAL SHEETS
5	SBT	-	-	6	9

REGISTERED STRUCTURAL ENGINEER  
Shawn W. Cutlers  
No. 55561  
STATE OF CALIFORNIA

PLANS APPROVAL DATE: \_\_\_\_\_

The State of California or its officers or agents shall not be responsible for the accuracy or completeness of scanned copies of this plan sheet.

CORNERSTONE STRUCTURAL ENGINEERING GROUP  
888 W. Alluvial Ave, Suite 201  
Fresno, California 93711  
(559)320-3200

SAN BENITO COUNTY PUBLIC WORKS DEPARTMENT  
2301 Technology Parkway  
Hollister, CA 95023

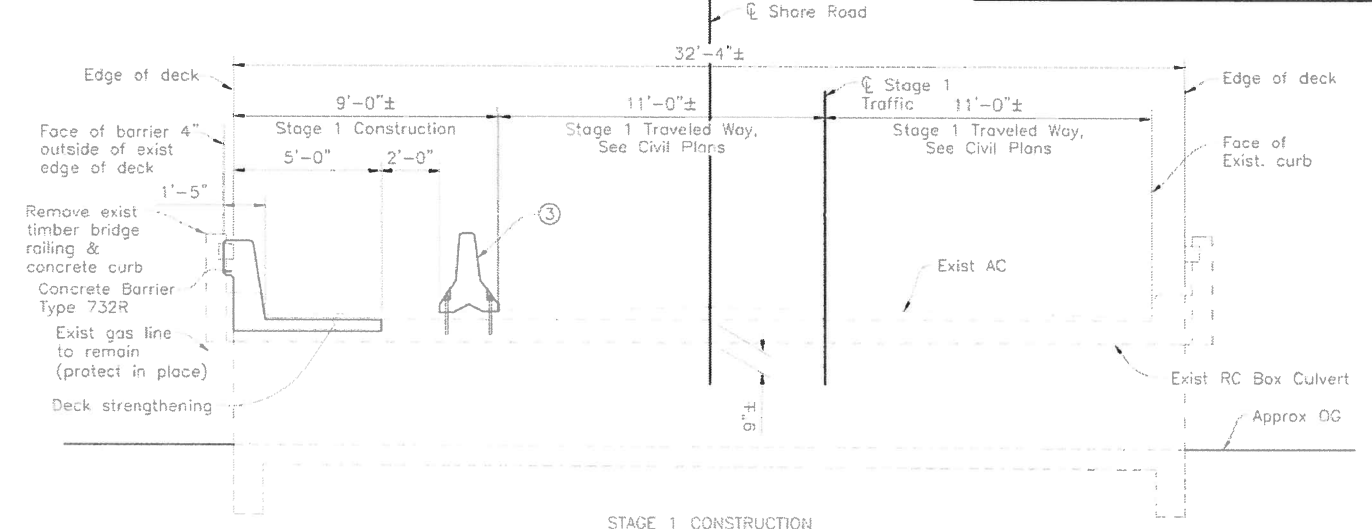

**STAGE 1 CONSTRUCTION**

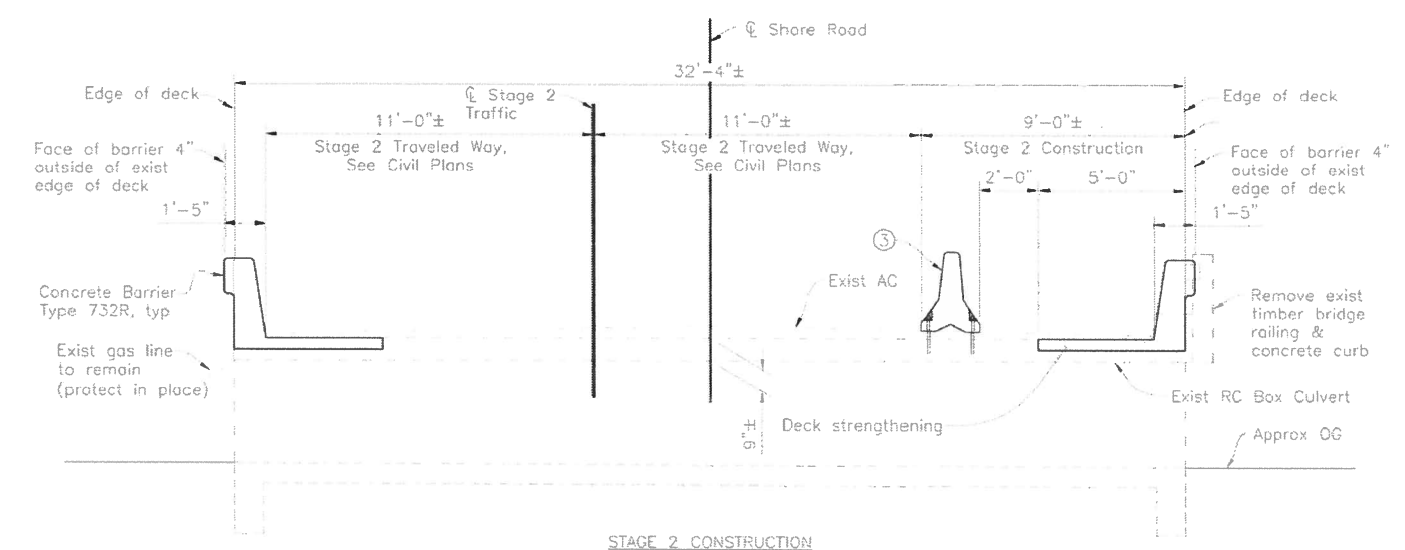

**STAGE 2 CONSTRUCTION**  
**TYPICAL SECTION**  
3/8"=1'-0"

**Note:**  
The contractor shall verify all controlling field dimensions before ordering or fabricating any material.

DESIGN OVERSIGHT	DESIGN BY: Narciso Zermeno	CHECKED: Mark Weaver	LRFD	LIVE LOADING: "LOAD & RESISTANCE FACTOR DESIGN" & "HS20-159 W/ 'LOW BOY' & PERMIT DESIGN VEHICLE"	PREPARED FOR THE COUNTY OF SAN BENITO PUBLIC WORKS DIVISION	PROJECT ENGINEER: Shawn Cutlers	BRIDGE NO.: 43C-0012	<b>SAN FELIPE RD &amp; SHORE RD BARRIER RAIL REPLACEMENT</b>	
DETAILS	BY: Narciso Zermeno	CHECKED: Mark Weaver	LAYOUT	BY: Shawn Cutlers	CHECKED: Mark Weaver	PROJECT ENGINEER	POST MILE: -	<b>GENERAL PLAN - SHORE ROAD</b>	
QUANTITIES	BY: Narciso Zermeno	CHECKED: Mark Weaver	SPECIFICATIONS	BY: Shawn Cutlers	PLANS AND SPECS COMPARED: Shawn Cutlers	PROJECT ID: CU EA	REVISION DATES: 4/6, 5/11, 1/23, 3/4	SHEET: 1	OF: 4

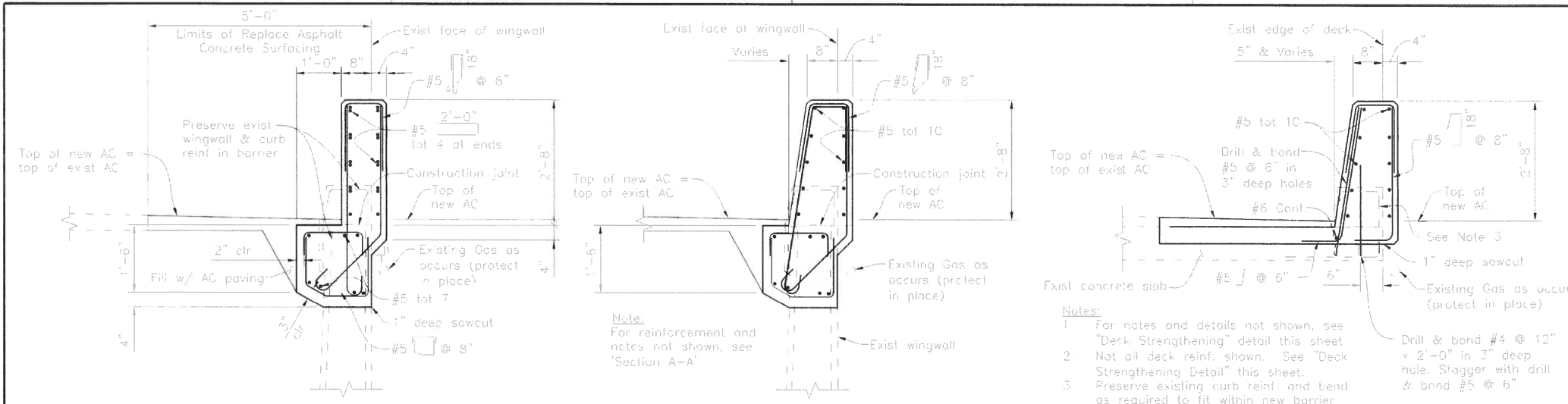

**SECTION A-A**  
3/4"=1'-0"

**SECTION B-B**  
3/4"=1'-0"

**SECTION C-C**  
3/4"=1'-0"

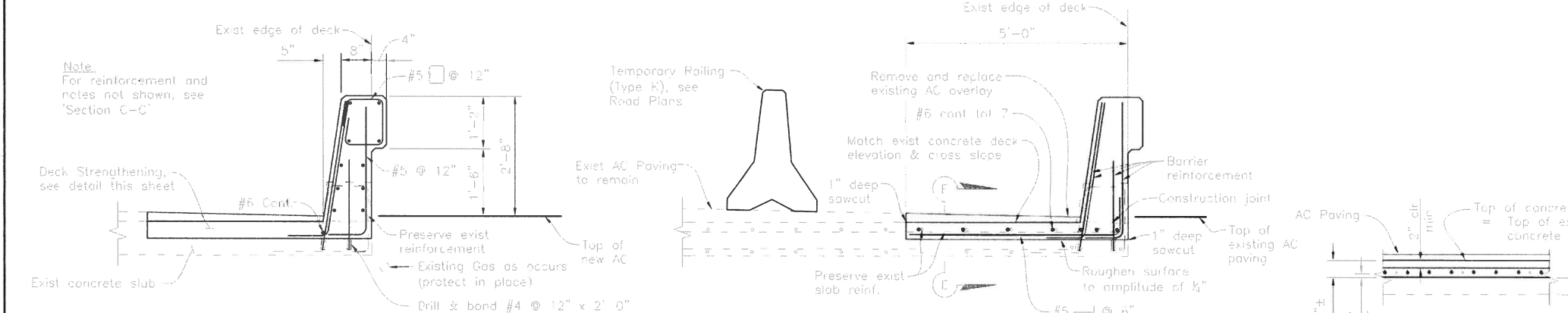

**SECTION D-D**  
3/4"=1'-0"

**DECK STRENGTHENING**  
3/4"=1'-0"

**SECTION E-E**  
3/4"=1'-0"

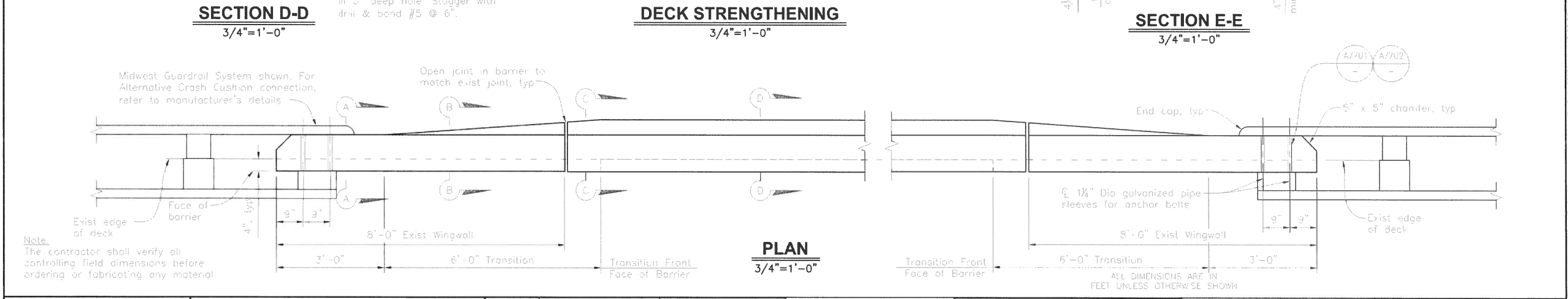

**PLAN**  
3/4"=1'-0"

POST MILES TOTAL PROJECT	SHEET NO.	TOTAL SHEETS
5	581	10

1/23/19  
REGISTERED STRUCTURAL ENGINEER

PLANS APPROVAL DATE: \_\_\_\_\_

CORNERSTONE STRUCTURAL ENGINEERING GROUP  
988 W. Alisal Ave, Suite 201  
Fresno, California 93711  
(559)329-3300

SAN BENITO COUNTY PUBLIC WORKS DEPARTMENT  
2301 Technology Parkway  
Hollister, CA 95023

- General Notes:**
1. Clearance to reinforcing steel in barrier to be 1" except as noted.
  2. For Midwest Guardrail System details, see Road Plans.
  3. For Alternative Crash Cushion, see Road Plans.
  4. Existing barrier rail not shown for clarity.
- indicates limits of bridge removal (portion)

- Deck Strengthening Notes:**
1. Remove exist AC overlay and concrete cover per the deck strengthening limits shown on the 'General Plan.' Chip concrete to 1" below exist and new transverse reinf. Preserve exist reinf steel. Contractor to use removal methods to ensure concrete to remain is not damaged.
  2. New reinf steel to match orientation of exist reinf steel.
  3. Place #5 reinf below longitudinal reinf at same level as exist transverse reinf.
  4. Place concrete slab.
  5. Place concrete barrier after concrete slab has achieved minimum f'c = 2.5 ksi.

DESIGN OVERSIGHT	DESIGN	BY	MARKER	CHECKED	DATE	BRIDGE NO.	PROJECT ENGINEER	PROJECT ID	DISREGARD PRINTS BEARING EARLIER REVISION DATES	REVISION DATE	SHEET	OF
	DESIGN	BY	Narciso Zermeno	CHECKED	Mark Weaver	43C-0012	Shawn Culers	43C-0012		4/8 5/11/23	2	4
	DETAILS	BY	Narciso Zermeno	CHECKED	Mark Weaver							
	QUANTITIES	BY	Narciso Zermeno	CHECKED	Mark Weaver							

DESIGN DETAIL SHEET (LENGTH) REV. 7/16/10

UPSCALE SCALE TO DIMENSIONS FOR REDUCED PLANS

PREPARED FOR THE COUNTY OF SAN BENITO PUBLIC WORKS DIVISION

SAN FELIPE RD & SHORE RD BARRIER RAIL REPLACEMENT  
BARRIER RAIL DETAILS - SHORE ROAD

FILE => W:\2014\2014044 Shore and San Felipe Barrier Rail Replacement\2014044S2 - Shore Road Barrier Rail Details.dwg



DIST	COUNTY	ROUTE	PERMETER POST TOTAL PROJECT	FILE NO.	TOTAL SHEETS
5	SBI	-	-	-	-

1/23/19

REGISTERED STRUCTURAL ENGINEER

PLANS APPROVAL DATE

*The State of California or its officers or agents shall not be responsible for the accuracy or completeness of original copies or this plan sheet.*

CORNERSTONE STRUCTURAL ENGINEERING GROUP 286 W. Alluvial Ave., Suite 201 Fresno, California 93711 (559)326-3300	SAN BENITO COUNTY PUBLIC WORKS DEPARTMENT 2301 Technology Parkway Hollister, CA 95023
--	---

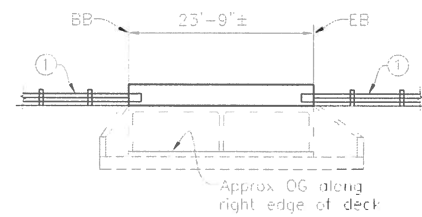

**ELEVATION**  
1"=10'-0"

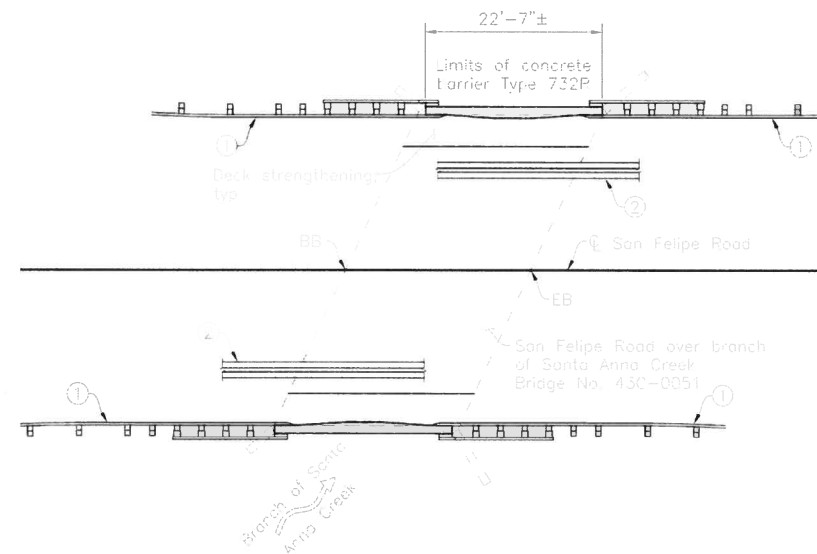

**PLAN**  
1"=10'-0"

- Legend:**
- ① MGS, see Road Plans
  - ② Temporary K-Rail, see Road Plans
  - Indicates approximate limits of bridge removal
  - - - Indicates existing structure
  - BO-3/3-1 Indicates Caltrans standard plan sheet no.
  - Indicates detail no.

**General Notes:**

Design: AASHTO LRFD Bridge Design Specifications, 6th Edition and the Caltrans Amendments Preface dated January 2014.

TL-4 Traffic Railing (F<sub>T</sub> = 54.0 Kips)

Reinforced Concrete: f'<sub>c</sub> = 3.6 ksi  
f<sub>y</sub> = 60 ksi  
n = 8.0

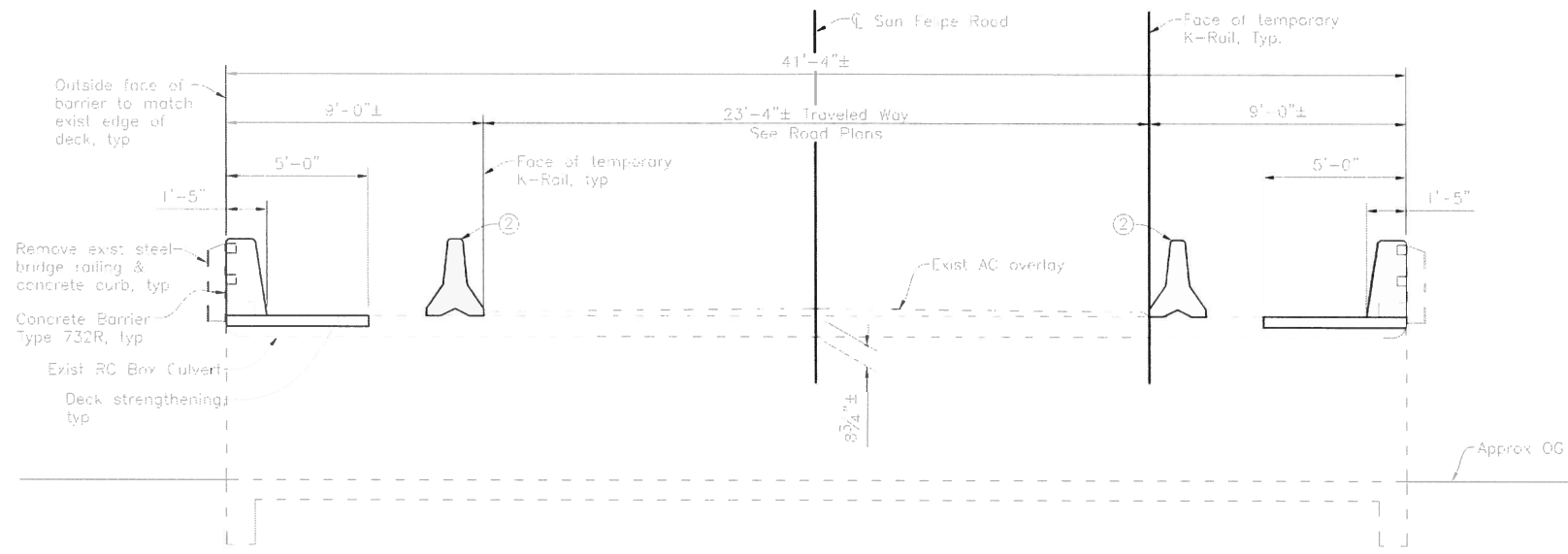

**TYPICAL SECTION**  
3/8"=1'-0"

**Note:**  
The contractor shall verify all controlling field dimensions before ordering or fabricating any material.

ALL DIMENSIONS ARE IN FEET UNLESS OTHERWISE SHOWN

DESIGN OVERSIGHT	BY: N	BY: Narciso Zermeno	CHECKED: Mark Weaver	APPD:	DATE: 11-13-07	PREPARED FOR THE <b>COUNTY OF SAN BENITO PUBLIC WORKS DIVISION</b>	PROJECT ENGINEER Shawn Cutlers	BRIDGE NO. 43C-0051	<b>SAN FELIPE RD &amp; SHORE RD BARRIER RAIL REPLACEMENT</b>		
DETAILS	BY: Narciso Zermeno	CHECKED: Mark Weaver	LAUNCH:	BY: Shawn Cutlers	CHECKED: Mark Weaver				<b>GENERAL PLAN - SAN FELIPE ROAD</b>		
QUANTITIES	BY: Narciso Zermeno	CHECKED: Mark Weaver	REVISIONS:	BY: Shawn Cutlers	PLANS AND SPECS COMPAILED:						

GENERAL SCALE IN INCHES FOR REDUCED PLANS: 0 1 2 3 4

PROJECT ID: CJ EA

DISKWARD PRINTS BEARING EARLIER REVISION DATES: 4/6 5/11/23

REVISION DATE: SHEET: 3 OF 4

DATE PLOTTED => 1/23/2019 TIME PLOTTED => 8:28:43 AM



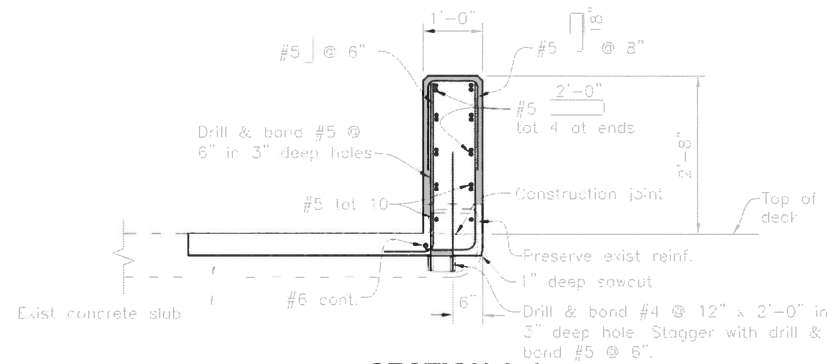

**SECTION A-A**  
3/4"=1'-0"

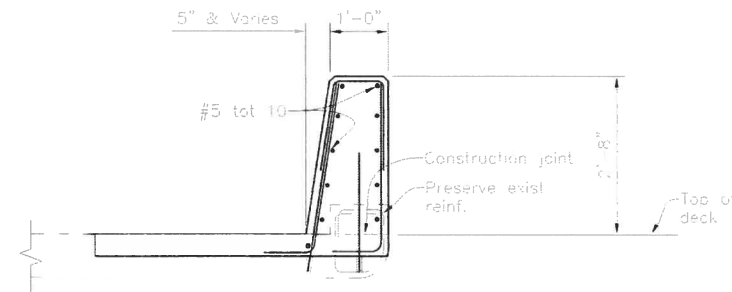

**SECTION B-B**  
3/4"=1'-0"

Note:  
For reinforcement and notes not shown, see Section A-A

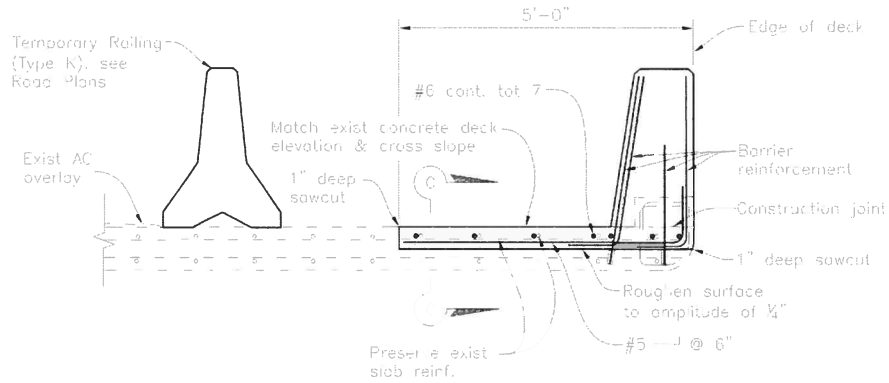

**DECK STRENGTHENING**  
3/4"=1'-0"

Note:  
The contractor shall verify all controlling field dimensions before ordering or fabricating any material.

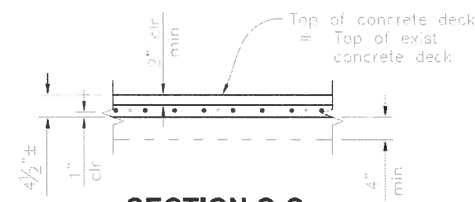

**SECTION C-C**  
3/4"=1'-0"

DIST.	COUNTY	ROUTE	POST MILES TOTAL PROJECT	SHEET No.	TOTAL SHEETS
5	S.B.			9	9
CORNERSTONE STRUCTURAL ENGINEERING GROUP 888 W. Alhambra Ave., Suite 201 Fresno, California 93711 (559) 733-1200					
SAN BENITO COUNTY PUBLIC WORKS DEPARTMENT 2301 Technology Parkway Hollister, CA 95023					

- General Notes:**
- Clearance to reinforcing steel in barrier to be 1" except as noted.
  - For Midwest Guardrail System details, see Road Plans.
  - Existing barrier rail not shown for clarity.
  - [ ] indicates limits of bridge removal (portion).

- Deck Strengthening Notes:**
- Remove exist AC overlay and concrete cover per the deck strengthening limits shown on the "General Plan." Chip concrete to 1" below exist and new transverse reinf. Preserve exist reinf steel. Contractor to use removal methods to ensure concrete to remain is not damaged.
  - New reinf steel to match orientation of exist reinf steel.
  - Place #5 reinf below longitudinal reinf at same level as exist transverse reinf.
  - Place concrete slab.
  - Place concrete barrier after concrete slab has achieved minimum  $f'c = 2.5$  ksi.

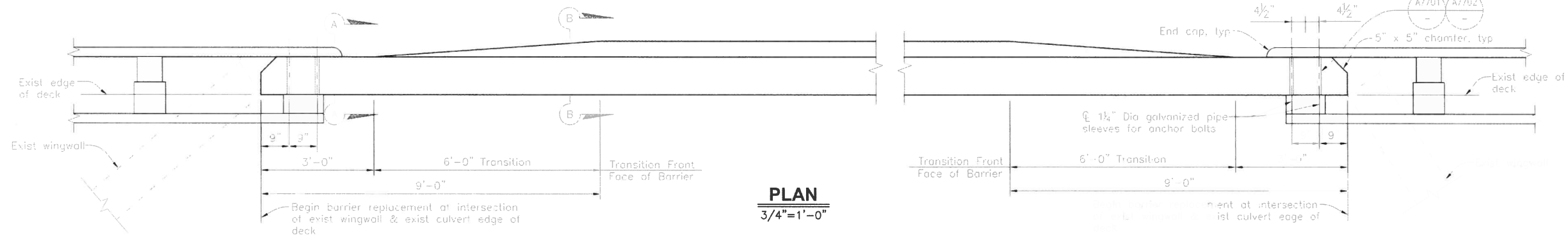

**PLAN**  
3/4"=1'-0"

DESIGN OVERSIGHT	DESIGN	BY Narciso Zermeno	CHECKED Mark Weaver	PREPARED FOR THE <b>COUNTY OF SAN BENITO</b> PUBLIC WORKS DIVISION	BRIDGE NO. 43C-0051	<b>SAN FELIPE RD &amp; SHORE RD BARRIER RAIL REPLACEMENT</b>
SIGN OFF DATE	DETAILS	BY Narciso Zermeno	CHECKED Mark Weaver			
DESIGN DETAIL SHEET (LENGTH) (REV. 7/19/10)	QUANTITIES	BY Narciso Zermeno	CHECKED Mark Weaver			
GRAPHIC SCALE IN INCHES FOR RED LINED PLANS				CU EA	DISPLACE BARRIER BEARING EARLIER REVISION DATES	REVISED DATE
					4/8	5/11/23
						4
						4