

STATE OF CALIFORNIA DEPARTMENT OF TRANSPORTATION PROJECT PLANS FOR CONSTRUCTION ON STATE HIGHWAY

IN SAN BENITO COUNTY
IN AND NEAR SAN JUAN BAUTISTA
FROM THE ALAMEDA
TO 0.2 MILE EAST OF
FOURTH STREET/BUSINESS
ROUTE 156 NEAR HOLLISTER

TO BE SUPPLEMENTED BY STANDARD PLANS DATED 2018

DIST	COUNTY	ROUTE	POST MILES TOTAL PROJECT	SHEET NO.	TOTAL SHEETS
05	SBT	156	3.0/R8.2		

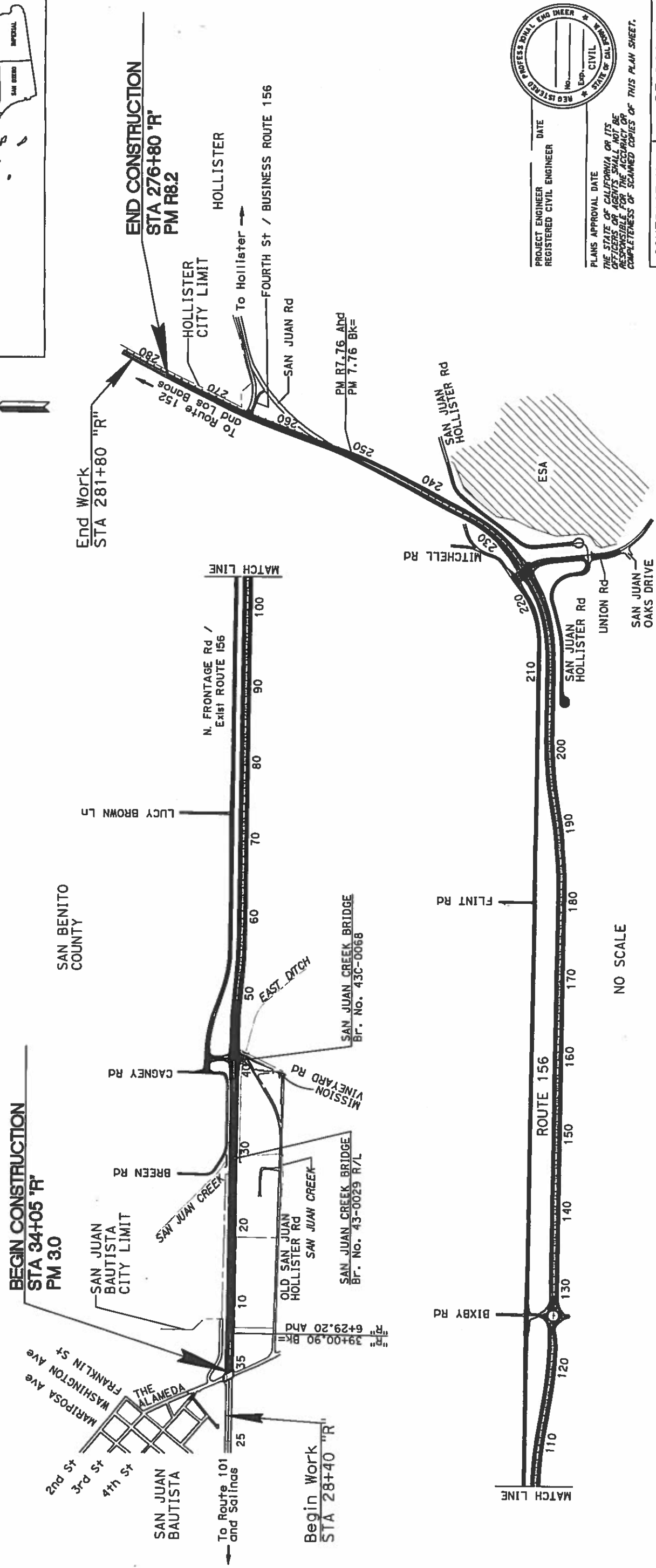
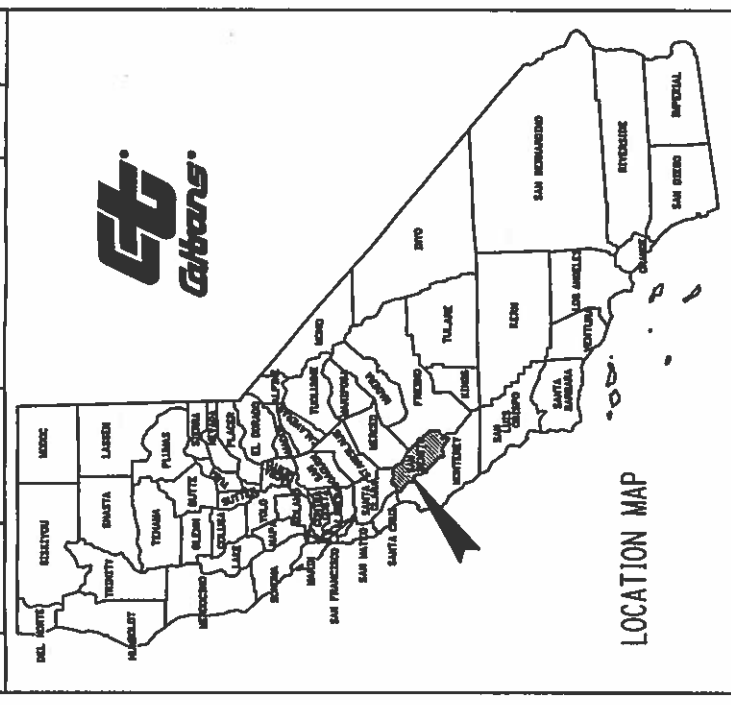

BEGIN CONSTRUCTION
STA 34+05 'R'
PM 30

Begin Work
STA 28+40 'R'

END CONSTRUCTION
STA 276+80 'R'
PM R8.2

NO SCALE

REGISTERED PROFESSIONAL ENGINEER
No. _____
Exp. _____
CIVIL
STATE OF CALIFORNIA

PROJECT ENGINEER REGISTERED CIVIL ENGINEER
DATE _____

PLANS APPROVAL DATE
THE STATE OF CALIFORNIA OR ITS OFFICERS OR AGENTS SHALL NOT BE RESPONSIBLE FOR THE ACCURACY OR COMPLETENESS OF SCANNED COPIES OF THIS PLAN SHEET.

CONTRACT No.	05-344904
PROJECT ID	0500000505

DESIGN ENGINEER	KAL DAHER
PROJECT MANAGER	BRANDY RIDER

THE CONTRACTOR SHALL POSSESS THE CLASS (OR CLASSES) OF LICENSE AS SPECIFIED IN THE "NOTICE TO BIDDERS."