

INDEX OF PLANS

STATE OF CALIFORNIA
 DEPARTMENT OF TRANSPORTATION
 PROJECT PLANS FOR CONSTRUCTION ON
 STATE HIGHWAY
 IN SAN BENITO COUNTY
 IN AND NEAR SAN JUAN BAUTISTA
 FROM THE ALAMEDA
 TO 0.2 MILE EAST OF
 FOURTH STREET/BUSINESS
 ROUTE 156 NEAR HOLLISTER

TO BE SUPPLEMENTED BY STANDARD PLANS DATED 2018

DIST	COUNTY	ROUTE	POST MILES TOTAL PROJECT	SHEET TOTAL SHEETS
05	SBT	156	3.0/R8.2	

LOCATION MAP



BEGIN CONSTRUCTION
 STA 34+05 "R"
 PM 3.0

END CONSTRUCTION
 STA 276+80 "R"
 PM R8.2

Begin Work
 STA 28+40 "R"

End Work
 STA 281+80 "R"

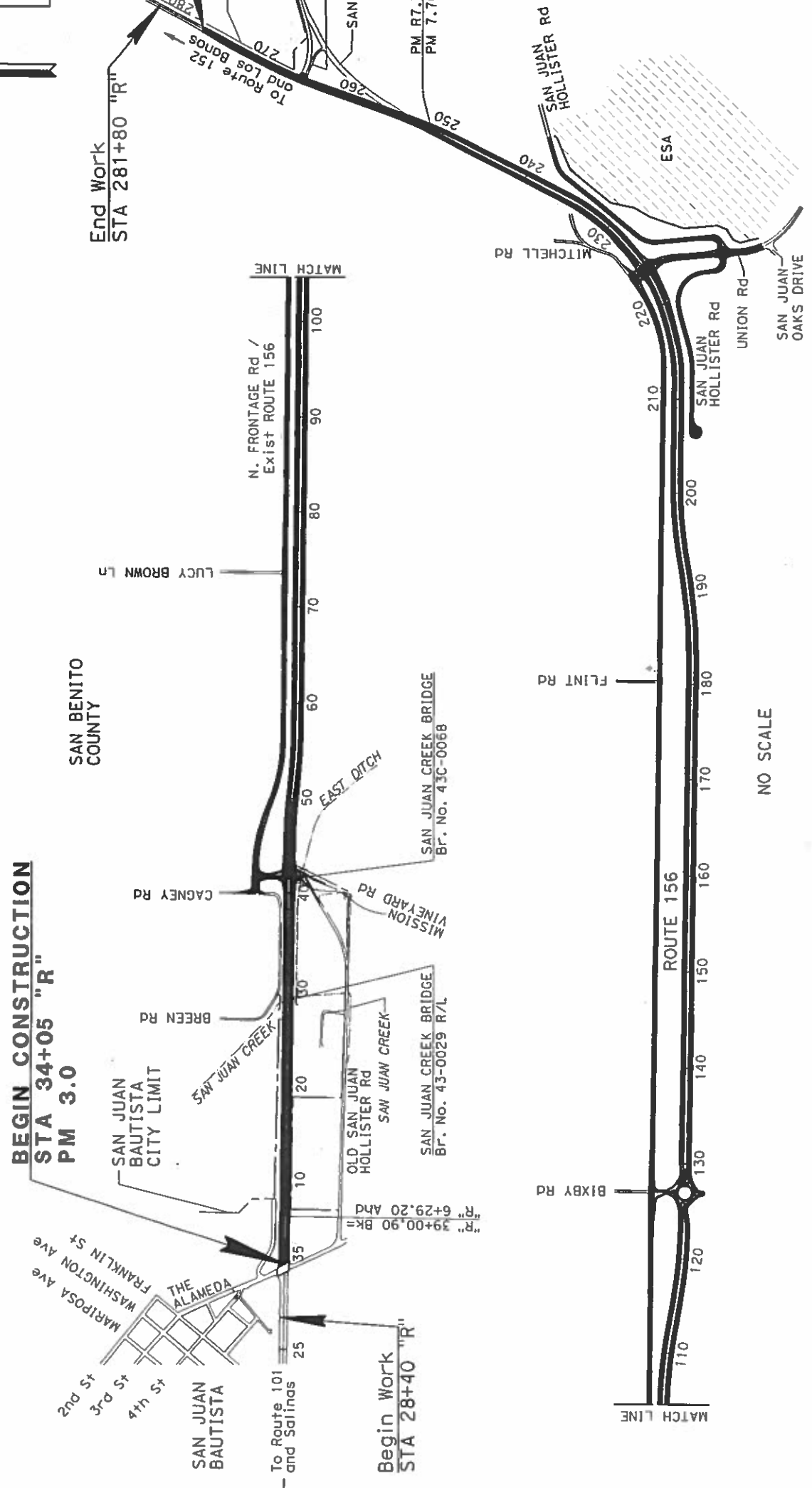

NO SCALE

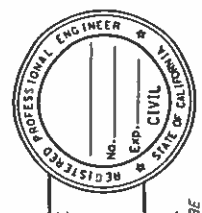

PROJECT ENGINEER
 REGISTERED CIVIL ENGINEER

DATE

PLANS APPROVAL DATE
 THE STATE OF CALIFORNIA OR ITS
 COUNTY ENGINEER SHALL BE
 RESPONSIBLE FOR THE ACCURACY OR
 COMPLETENESS OF SCANNED COPIES OF THIS PLAN SHEET.

CONTRACT No. **05-344904**
 PROJECT ID **0500000505**

UNIT 1443 PROJECT NUMBER & PHASE 0500000505

PROJECT MANAGER
 BRANDY RIDER

DESIGN ENGINEER
 KAL DAHER

THE CONTRACTOR SHALL POSSESS THE CLASS (OR CLASSES) OF LICENSE AS SPECIFIED IN THE "NOTICE TO BIDDERS."

BORDER LAST REVISED 9/30/2012 CALTRANS WEB SITE IS: [HTTP://WWW.DOT.CA.GOV/](http://www.dot.ca.gov/)

RELATIVE BORDER SCALE 0 1 2 3
 15 IN INCHES
 USERNAME: s128672
 DGN FILE: 0500000505050001.dgn

DATE PLOTTED: 16-OCT-2018
 TIME PLOTTED: 13:12