

GENERAL

The 24-Hour Library is designed for indoor or outdoor installation provided that an approved overhang, canopy or other covering protects the system from rain and snow.

In addition to protecting patrons, the covering should protect the 24-Hour Library from the elements, including rain, snow and dust. Environmental and other considerations are discussed in detail later in this document.

The Library is responsible for preparing the site including the slab, canopy or covering, Internet access, electrical power, permits and other physical plant requirements.

EnvisionWare provides an optional canopy with installation services that conforms to all of the requirements necessary to properly cover the system outdoors in temperatures that fit the operating range specified in the 24-Hour Library product specifications that can be found at <https://www.envisionware.com/24-hour-library/>



Photo of Model 24L-235 24-Hour Library



www.envisionware.com

© 2014-2017 EnvisionWare, Inc. | All Rights Reserved
24L-285_SitePrep_Planning_6.0

EnvisionWare, Inc. Corporate Headquarters
2855 Premiere Parkway, Suite A
Duluth, GA 30097-5201
Toll Free 800-216-8370
Direct +1 (678) 382-6500

ENVISIONWARE®

LEFT SIDE SIGN

The second backlit sign panel is on the left side of the system, and is the secondary brand identity of your system and typically contains the name of your library system and the name of the branch.



Left side dimensions: 36.22" wide x 8.66" high
(920mm wide x 220mm high) *

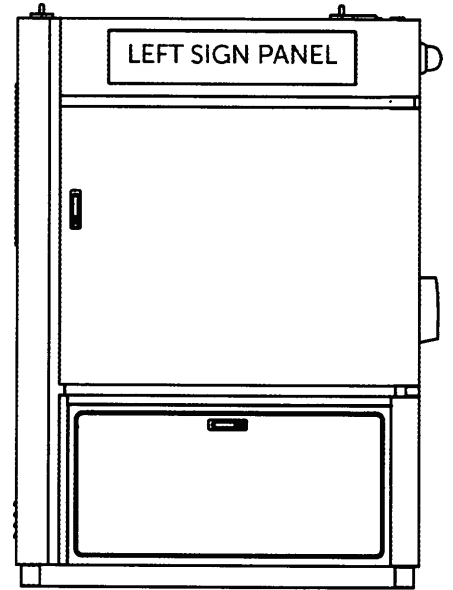

RIGHT SIDE TOUCH SCREEN (Program / Promotional)

The second display is a 43-inch touch screen. As delivered this screen runs a continuous PowerPoint presentation that promotes the functions of the system. Over time you may repurpose this display for tasks such as newspaper readers, news feeds or other information you wish to present to the public.

EnvisionWare provides a 'generic' PowerPoint slide presentation running in the free viewer application. Any changes in content or the use of other applications used on this display are at the discretion of the library. EnvisionWare does not provide PowerPoint training or customization.

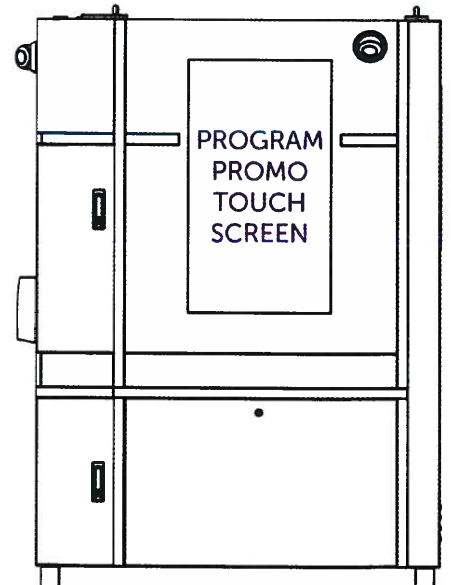

** Visible dimensions. These do not represent the final film sizes.*

Rigging

Rigging is the equipment and process of offloading the system from the truck and moving it into place. The truck arrives at your installation site. A set of fork trucks is used to offload the system and move it to the slab.

NOTE: During the delivery and locating process it is important to keep staff and public away from the system for safety purposes.



Fork Truck Offloading 24-Hour Library

The EnvisionWare Implementation Consultant will manage the process of assessing the route for offloading and placement and will review the requirements necessary to ensure that no damage occurs to existing structures. These concerns are addressed during the planning phase.

Setting the System in Place

Once the 24-Hour Library is off the shipping truck, the pallet and crate will be placed on the ground where the covers can be removed from the system. The Library will then be lifted off of the shipping pallet for placement on-site.

It is recommended that the slab or surface for the 24-Hour Library be marked with the outline of the machine for placement of the machine before it shows up on-site. Use the dimensions drawing provided in earlier in this document. Your Implementation Consultant will work with you to coordinate this task. Duct tape can be used to show the outside edges of the machine. At a minimum, the back of the machine should be marked and the center line for the machine.

The machine will be placed into its final location with a combination of machine skates and fork trucks, and manual labor.

The packaging materials including lumber, shrink-wrap, tarps, ratchet straps, cardboard and foam wrap will be removed under the direction of the Implementation Consultant.

Packaging

The 24-Hour Library will be delivered to the installation site on a wood pallet. Ratchet straps hold the machine and covers to the pallet as shown in the photo below.



24-Hour Library on Pallet

The pallet is constructed of lumber and can be disposed of once the machine is on site. The system is protected during shipment with a 2-tarp system that protects the machine from the elements and keeps the machine free from dust and dirt during shipping. Both of the tarps that protect the 24-Hour Library during shipment can be disposed of once the machine is off loaded from the pallet.

NOTE: EnvisionWare assumes responsibility for removal of all packing materials.

ENVISIONWARE®

EnvisionWare Canopy Delivery

Delivery of the canopy is accomplished through bundles of banded components per the photo below. Generally, there are five (5) separate banded bundles that will be delivered to your installation site.



EnvisionWare Canopy Delivery Packaging

EnvisionWare Canopy Minimum Slab Requirements

The minimum recommended concrete slab for the canopy is based on the minimum size that will accommodate the canopy and machine dimensions while accommodating ADA requirements. The specific slab design will vary according to local and regional building code requirements. Every EnvisionWare canopy has a set of Structural Engineered drawings that contain the respective state's Structural Certification Stamp. Each canopy design also comes with a complete set of calculations demonstrating the building codes that are met with the canopy design.

Canopy Colors

The standard colors for the EnvisionWare canopy are Almond (RAL 090 80 10) for the supporting structure and Charcoal (RAL 000 40 00) for the roof. Other color schemes for the structure and roof are available as options.



Almond

EnvisionWare Canopy Post/Structure
Color



Charcoal

EnvisionWare Canopy
Roof Color

MSC Specifications (Front)

- Intel J1900 Quad-core Processor
- 120G SSD
- 4G RAM • 8 USB
- 6 RS232
- 1 HDMI
- 2 VGA
- 1 LPT
- 2 Giga LAN Main System Controller Computer
- 12v power
- FCC Approved
- Display: 17" Elo Touch Screen
- Windows 7 Professional 32-bit US English
- 24L Application Software Package
- Microsoft Security Essentials
- Central Management (NetSupport) Client Software

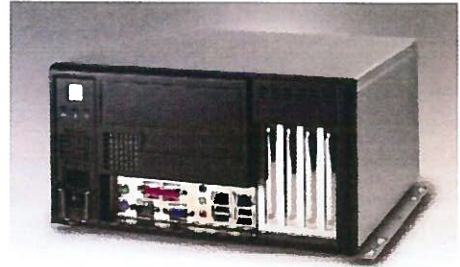

Program/Information Specifications (Right Side)

- Advantech: Atom D525 Fanless Ecosystem
- Processor: Atom D525 Dual-core processor
- RAM: 2G DDR2
- Hard Disk: 320GB
- Ports (1) RS-232 | (8) USB
- Power: UL Listed 120-240V 23W
- Display: 43" Elo Touch Screen
- UL listed / FCC approved
- PowerPoint Viewer
- Standard PowerPoint slide presentation



Program Display Computer

NOTE: Specifications are subject to change without notice. Equivalent or better substitutions may be made in the interest of improved designs.

LAN (NETWORK)

The 24-Hour Library is prepared to accept an RJ45 connection to the internal router.

An internal power strip is available for connecting a modem or other Internet device.

The 24-Hour Library operates a private internal network. The included 2-Channel Wi-Fi Hotspot can deliver “no password” Internet access to patrons and password-protected VPN access for staff, which is particularly useful when scheduling a rollout or registration event.

Network Connectivity

The following describes the network connectivity between the 24-Hour Library internal Sophos Router, the library firewall/router and the services hosted by EnvisionWare.

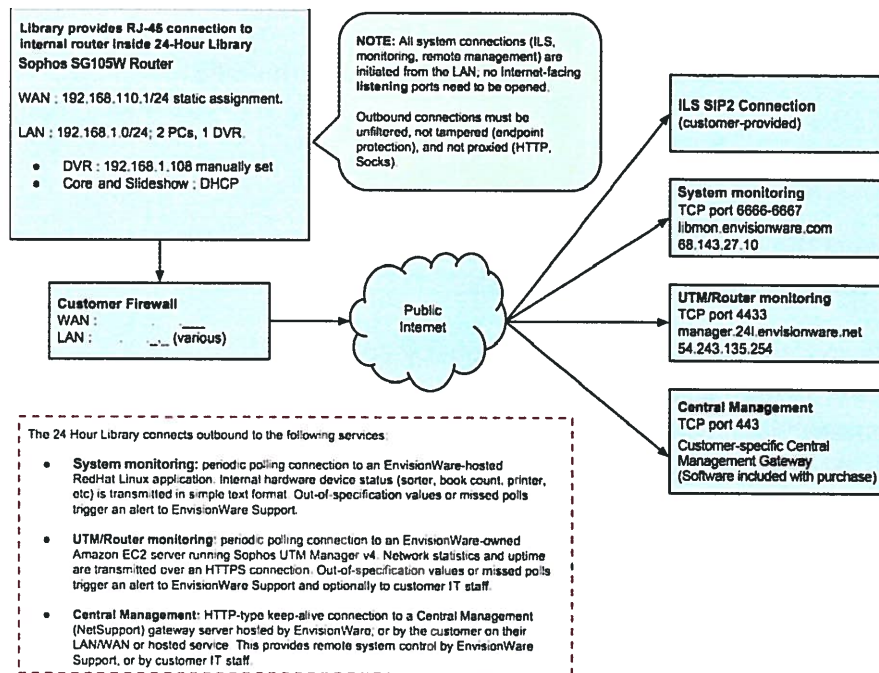

Network Connectivity - 24-Hour Library

Rear Conduit Entry

Conduit enters the rear left panel the system includes a weatherproof conduit cover.

BACK

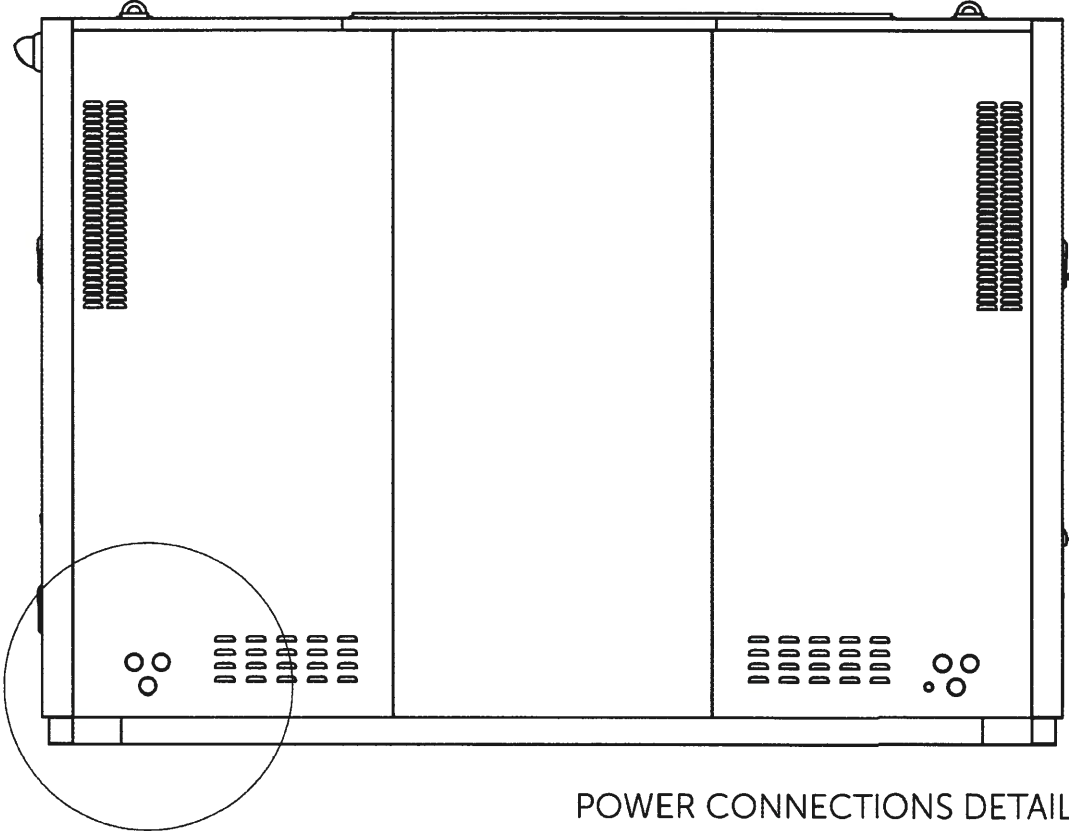

POWER CONNECTIONS DETAIL

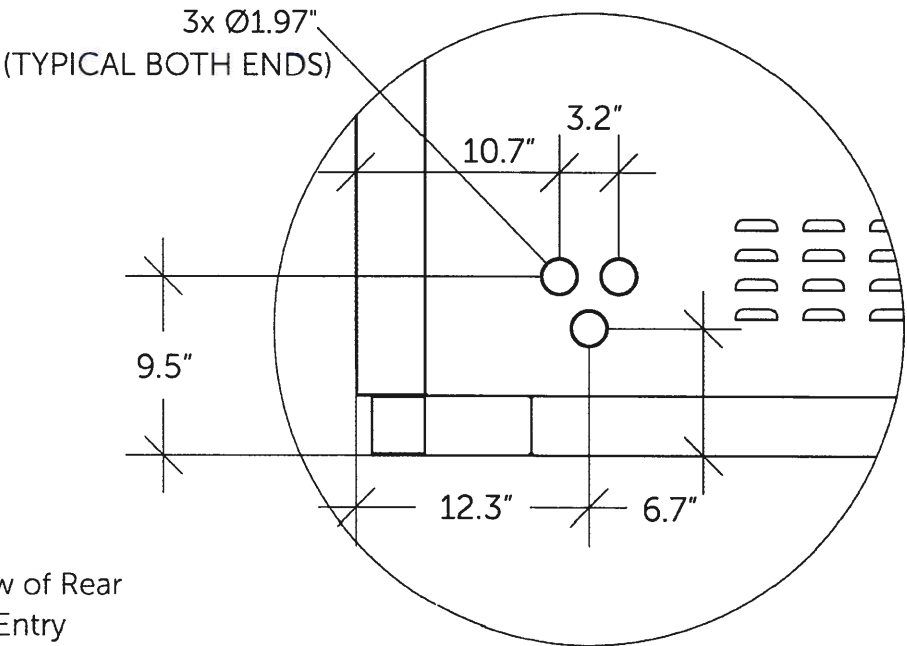

Cutaway View of Rear Conduit Entry